



**METRO  
DESIGN  
GROUP**

ARCHITECTURE-PLANNING-INTERIORS

1475 S. BASCOM AVE SUITE 208  
CAMPBELL, CA 95008  
(408)871-1071 phone  
(408)871-1072 fax  
www.metroarchitects.com

The plans, ideas and design on this drawing are the property of the designer, devised solely for this contract. Plans shall not be used, in whole or in part, for any purpose for which they were not intended without the written permission of METRO DESIGN GROUP. ©

PROJECT NAME

**PROPOSED  
RESIDENCE**

15487 BOHLMAN ROAD  
SARATOGA, CA 95070

REVISIONS

NO.	DESCRIPTION

**PROPOSED  
GARAGE & LOWER  
FLOOR PLAN**

DATE : 1-11-18  
SCALE : 1/4" = 1'-0"  
DRAWN BY : TS  
CHECKED BY : TS  
ARCHITECT : TOM SLOAN  
PROJECT NO : 17642

SHEET NUMBER

**A-2**

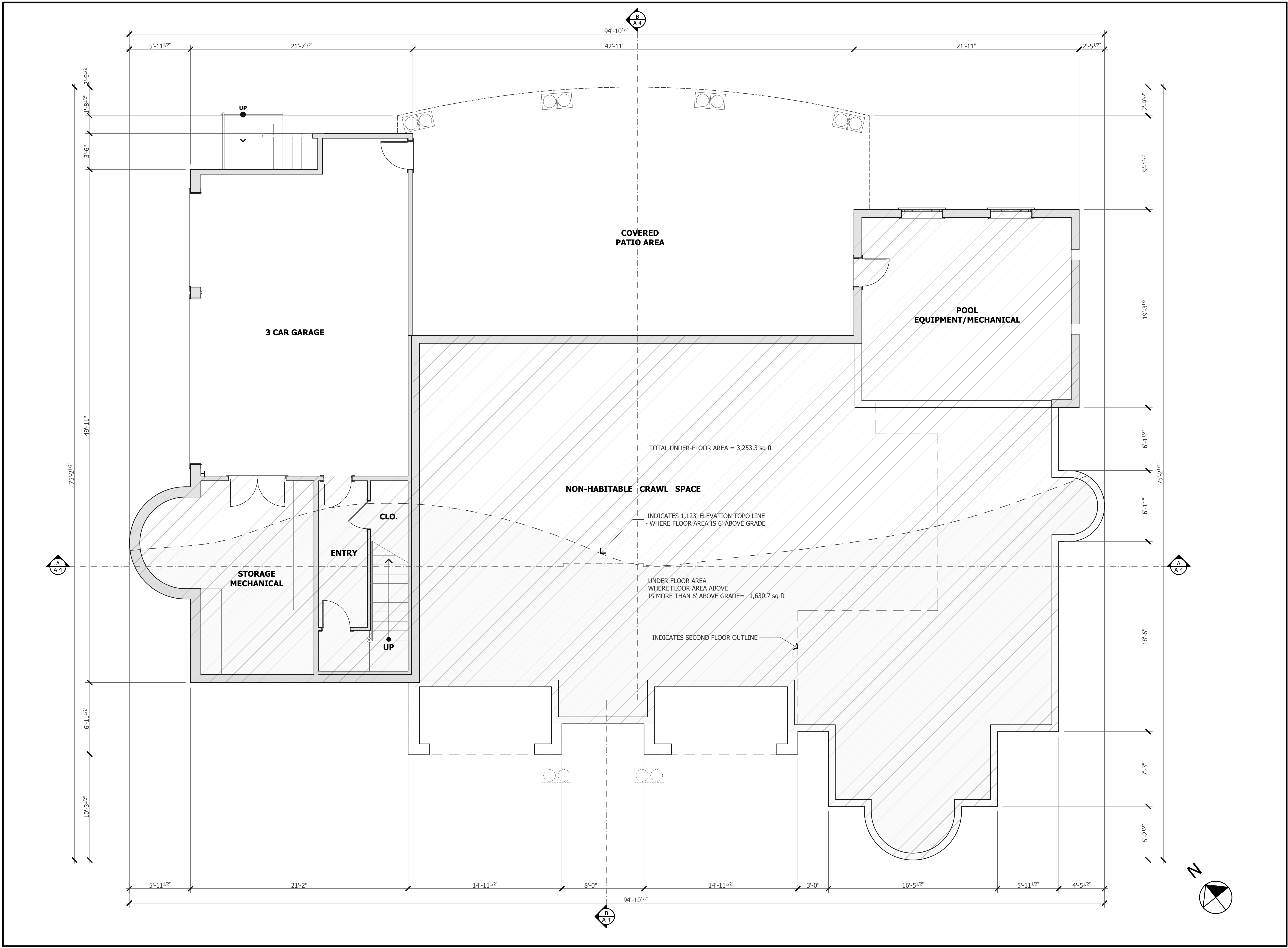

1/12/2018 1:58 PM  
PZ Development 1-15-18.pln