



MARTIAL COTTLE PARK



LEGEND

- | | | | |
|--|--------------------------------------------------------|--|-------------------------------------------------|
| | Ranger Station/Visitor Center
Phone: (408) 535-4060 | | Paved Road |
| | Entry Kiosk & Pay Station | | Park Road (Bicycles OK) |
| | Parking | | Service Road (No Public Access) |
| | Gate | | Trail Distance (miles) |
| | Restrooms | | Creek |
| | Picnic Area | | Private Property |
| | Reservable Group Picnic Area | | Future Use Area (No Public Access) |
| | | | Agriculture Area (Lessee & Invitee Access Only) |
-
- | | |
|-----------|-----------------------------------|
| TRAIL USE | |
| | Hiking |
| | Paved Hiking |
| | Hiking/Equestrian/Bicycling |
| | Paved Hiking/Equestrian/Bicycling |

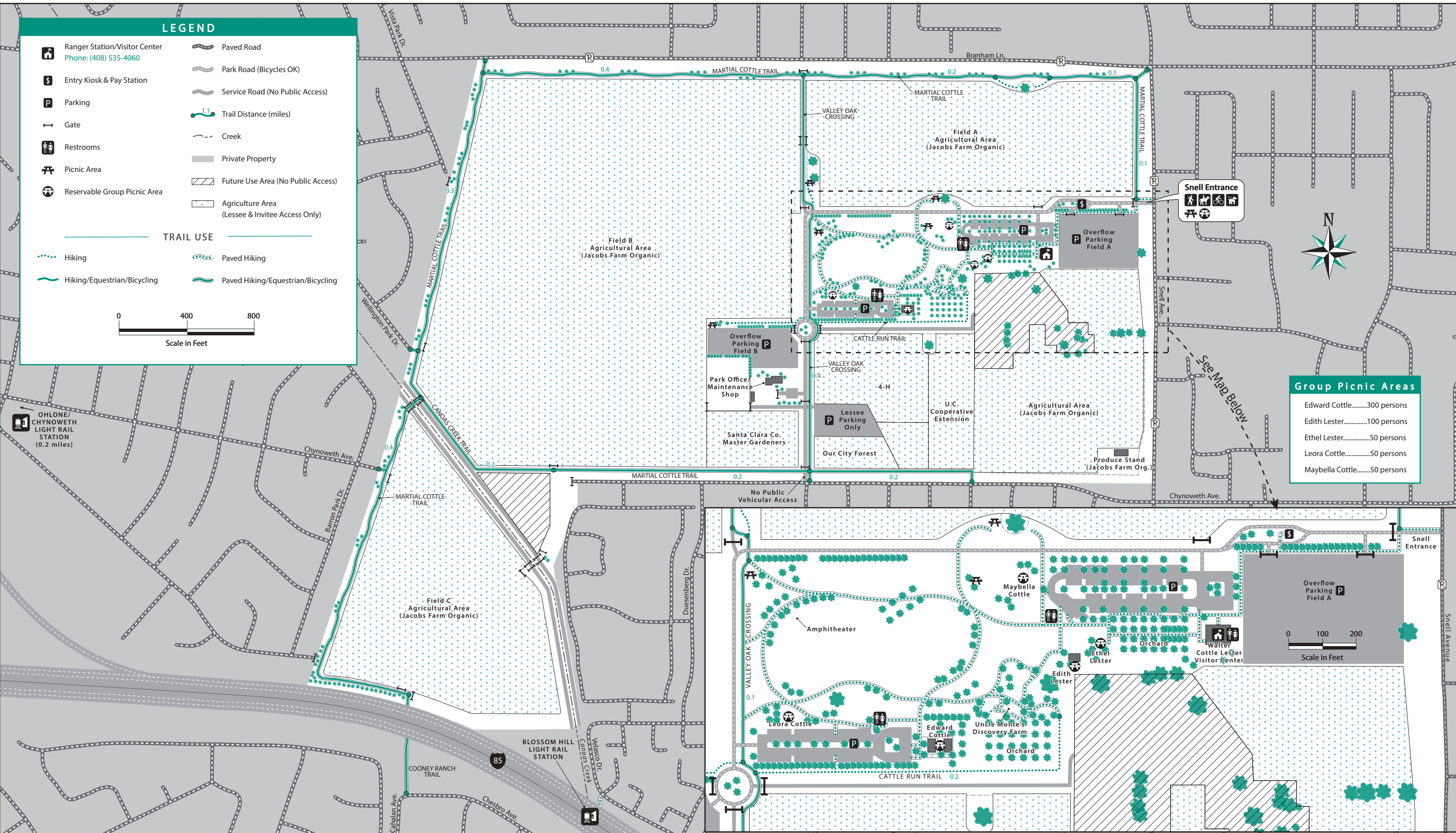
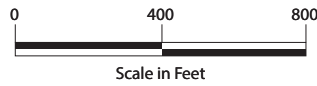

Group Picnic Areas

- Edward Cottle.....300 persons
- Edith Lester.....100 persons
- Ethel Lester.....50 persons
- Leora Cottle.....50 persons
- Maybella Cottle.....50 persons

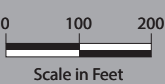

OHLONE/CHYNOWETH LIGHT RAIL STATION (0.2 miles)

BLOSSOM HILL LIGHT RAIL STATION

See Map Below